



BoxPicker® Automated Pharmacy Storage System

BoxPicker is part of an end-to-end integrated solution of Swisslog Healthcare equipment and software that controls and manages medication from wholesaler to patient.



BoxPicker® Automated Pharmacy Storage System

BoxPicker is part of an end-to-end integrated solution of Swisslog equipment and software that controls and manages medication from wholesaler to patient.

BoxPicker provides pharmacies with secure, high-density storage of medications-controlling access, improving pharmacy workflow efficiency and expediting the picking process.

This high-performance system significantly minimizes the need for static shelving and is a robotic alternative for vertical carousels and refrigerated drug storage.

BoxPicker fully automates medication storage and retrieval; which not only eliminates picking errors and increases safety at dispense, but also creates a more efficient pharmacy workflow- allowing the pharmacy staff to focus on revenue generating tasks and spend less time locating, picking and verifying medications.

«The security of a single dispensing and loading point provides peace of mind regarding access and accountability.»¹

SOURCE

1 — Dave Webster, RPh, MSBA. Associate Director Pharmacy Operations, University of Rochester Medical Center

BoxPicker Advantages

- Fully Automated
- Modular
- Guaranteed Control
- Requires No Floor Reinforcement

Fully Automated

- All items are brought to a single operator station for retrieval and verification
- Multiple operator stations allow for simultaneous operations, improving efficiency
- Users have no exposure to internal moving parts, increasing safety
- Picks the next order ahead of the user for enhanced picking productivity

Modular

- Allows for easy expansion options as pharmacy needs change and grow
- Versatile configurations provide a greater return on your investment

Guaranteed Control

- Limited access, scan in and scan out technology decreases opportunity for error
- Password-protected operator access ensures inventory control and audit capabilities

Requires No Floor Reinforcement

- Equal weight distribution, rarely requiring additional reinforcement

«[...] The BoxPicker has allowed our storeroom staff to focus more on critical service issues and improve our efficiencies around managing stock.»¹

SOURCE

1— Dave Webster, RPh, MSBA. Associate Director Pharmacy Operations, University of Rochester Medical Center



BoxPicker Features and Benefits



1 Controlled Access

Allows access to a single box at a time, eliminating picking errors

2 Barcode Verification

Scan in and scan out technology increases safety at dispense

3 Configurable Workstations

Allows for workstations on both sides or direct anteroom access to reduce extra steps

3 Multiple Workstations

Allows for secure, simultaneous operations

4 Touchscreen Interface

Simplifies user access and information retrieval

4 Secure Operator Access

Password-protection ensures inventory control and audit capabilities

+ Emergency Support

Provides fully accessible inventory in the event of a power failure

+ Modular Design

Accommodates ambient, refrigerated and dual-temperature storage requirements

«The Swisslog Healthcare BoxPicker reduced daily ADC pick time by 26 to 32 minutes and reduced the time to pick patient-specific first doses 4-5 fold. The efficiencies gained thus far have allowed pharmacy to reduce drug to patient turn-around time, curtail ADC stock outs, allocate additional resources to sterile compounding, and spend more time on medication reconciliation and transition of care activities.»¹

SOURCE

¹ — Richard Mendribil, BS, PharmD, Health System Director of Pharmacy Services at Northern Arizona Healthcare, “BoxPicker by Swisslog” *Pharmacy Purchasing & Products* Vol. 12 No. 5 May 2015



BoxPicker How it works

Designed to eliminate the need for static shelving, BoxPicker allows you to focus on clinical tasks and spend less time locating, picking and verifying medications. BoxPicker is the ultimate pharmacy storage solution.

Loading

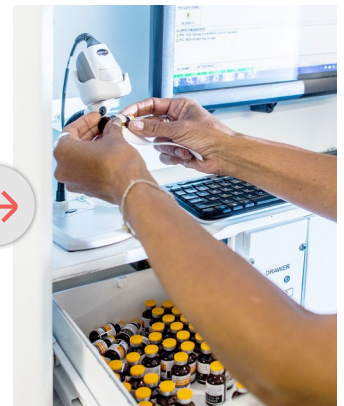
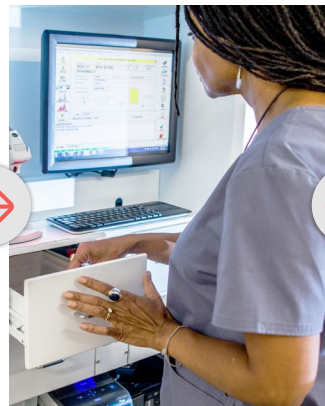

1 · A technician logs into the BoxPicker operator station and selects the «Load» option

2 · A technician scans the medication to be loaded and enters the quantity and expiration date

3 · BoxPicker retrieves the appropriate medication box based on space availability and delivers the box to an access drawer at the operator station

4 · Once the box has been delivered, the technician opens the access drawer, scans the medication to be loaded and places it in the assigned location

Dispensing



1 • A technician logs into the operator station and selects an order received through an interface with the hospital's information system and/or ADC¹ vendor



2 • BoxPicker picks only the correct medication box and places it in an access drawer at the operator station



3 • Once the box has arrived, a green light indicates the drawer is unlocked and can be opened

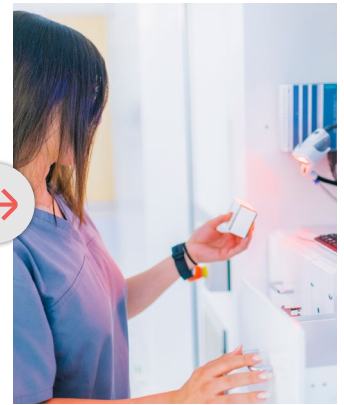

4 • A technician then picks the correct medication from the box and scans the product barcode for verification



5 • Once the medication has been scanned and confirmed, the inventory quantity is updated in the system



6 • While the technician scans one product out, BoxPicker is already retrieving the next medication box to be dispensed



SOURCE

1 — Automated Dispensing Cabinet

BoxPicker Configured for Your Facility

Each pharmacy's needs are different. BoxPicker allows you to customize its configuration to meet your requirements. As your pharmacy needs evolve, you can expand your system by adding modules, rather than having to invest in another piece of equipment.

Modules

Full modules consist of 240 boxes and four high-capacity drawers for larger items. Workstation modules combine a computer, barcode scanner, four access drawers and up to 196 boxes. Systems are configured from the following options:

Operator Stations

Supports additional operator stations for simultaneous system access on the same or opposite side of the BoxPicker System.

Ambient Modules

Store unit dose and bulk medications that do not require special handling or temperature control.

Dual-Temperature Modules

Eliminate the need for separate pharmacy refrigerators by storing temperature-sensitive items in a refrigerated half module.

Fully Refrigerated Model

Replace standard pharmacy refrigerators to streamline workflow and improve inventory control for all of your refrigerated medications.

Cleanroom Access

BoxPicker supports USP <797> compliance by providing a secure pass-through to anterooms. Its positive-pressure airflow ensures the integrity of anteroom and cleanroom environments. By installing a workstation on the opposite side of the BoxPicker, pharmacies can:

- Increase efficiency by enabling staff to retrieve compounding supplies and medications without having to leave the cleanroom environment
- Load the BoxPicker on the pharmacy side and retrieve products directly in the anteroom
- Eliminate the need to gown up and enter the cleanroom to deliver inventory

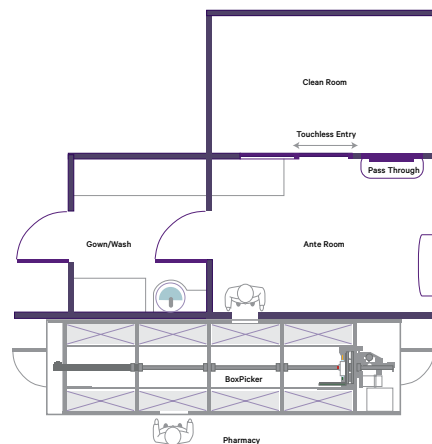

CONTACT

Swisslog Healthcare
healthcare.us@swisslog.com
800.764.0300
Canada: 877.294.2831 | 905.629.2400
swisslog-healthcare.com/boxpicker

BoxPicker and PillPick are registered trademarks of Swisslog AG. Swisslog Healthcare systems may be covered by one or more patents. See [swisslog-healthcare.com/patents](https://www.swisslog-healthcare.com/patents) for details.
© 2019 Swisslog Healthcare EN NAM 102019 BPS-100